

7 in 1.

The KWL[®] MultiZoneBox. 

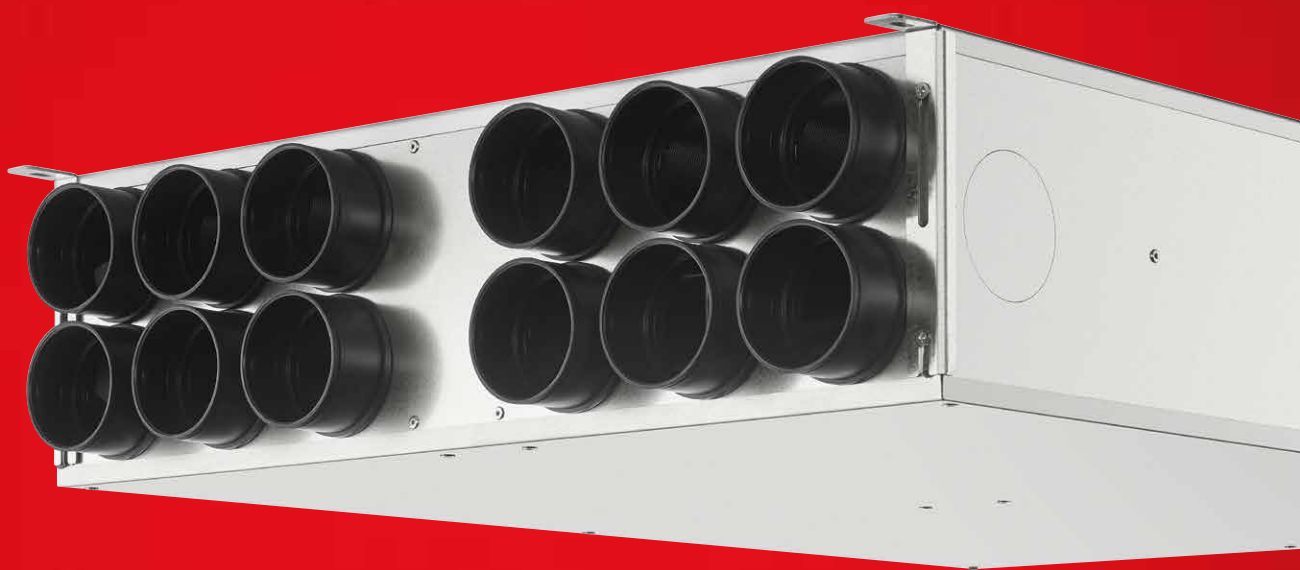

* For the compact supply and extract ventilation
of residential and commercial units.



Good.



2 air distribution boxes.



2 volume flow controllers.



2 sound attenuators.



1 system control.

Better.



 **7** components in one box.

Volume flow control, sound attenuation, air distribution and system control – solve seven problems at once with the new KWL® MultiZoneBox.

In combination with a central building KWL® unit, the MultiZoneBox ensures the silent, demand-oriented supply and extract ventilation of residential and commercial units.

Then there are our renowned quality and reliability. And, of course, the installation and commissioning of this compact system are particularly simple and safe.

Sometimes less truly is more.

Both this and that.

The flexible system for residential and commercial units.

Both classic and modern.

The MultiZoneBox is compatible with all ducts. Spiral ducts can be connected as easily as the flexible plastic ducting system FlexPipe® plus. There are no limits to the possibilities.

Both for work and at home.

The MultiZoneBox guarantees reliable air distribution for almost all areas of application. Thus, it is the perfect solution for residential and commercial units – whether it is a single apartment or maisonette – an office complex or loading area, or all together.

Both now and tomorrow.

One box instead of multiple individual components reduces the planning cost in advance and saves valuable installation space. The maintenance-freedom, highest functional reliability and silent operation are convincing in practical use.

Both high-performance and demand-based.

If multiple KWL® MultiZoneBoxes are used to ventilate a large unit, such as e.g. a practice, different zones can be independently supplied with different volumes of air based on demand.

Both inside and outside, above and below.

Whether the ventilation system is installed in the basement or on the roof, inside or outside – the KWL® MultiZoneBox always ensures the ideal air distribution with each ventilation unit.

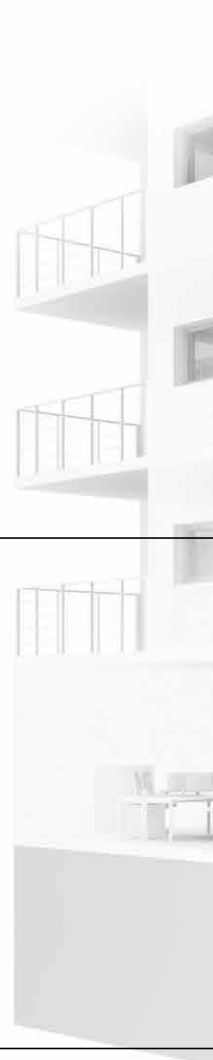

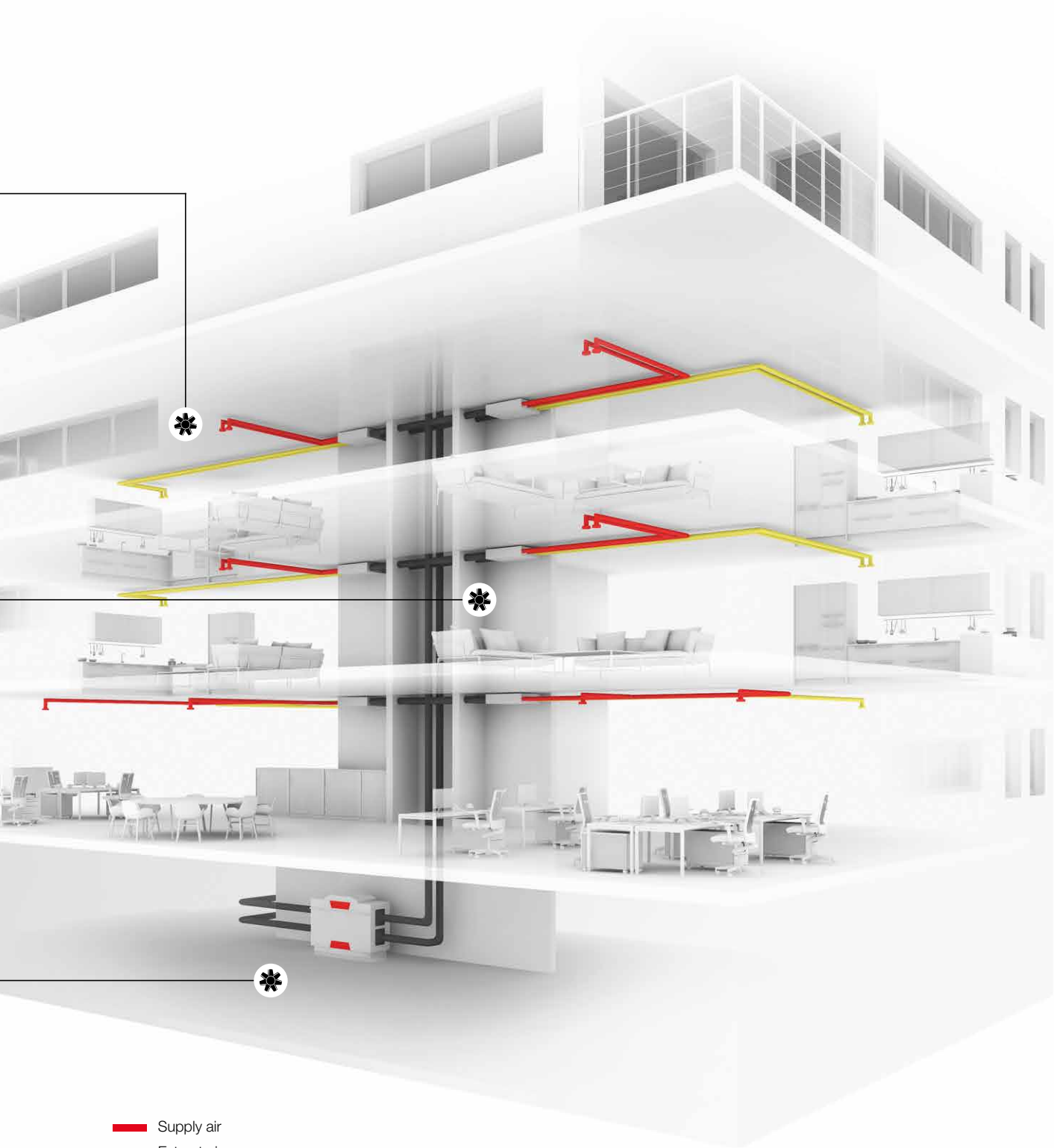

- Supply air
- Extract air

Full of great ideas. There's more to it than it seems.

Always fits.

The right box for every requirement. Whether for ceiling or wall installation, spiral duct or plastic duct – select “your” MultiZoneBox.

Brilliantly quiet.

The large-scale sound attenuation elements ensure silent operation. Thus, the MultiZoneBox is especially suited for noise-sensitive environments.

All automatic.

The optional room air sensor turns the MultiZoneBox into a complete demand-driven ventilation unit. Manual user intervention is not required.

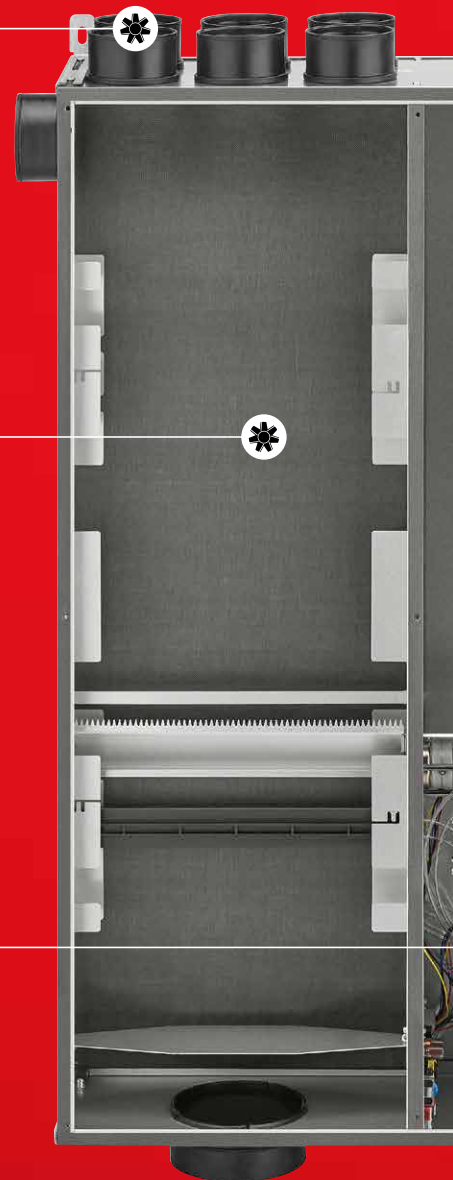

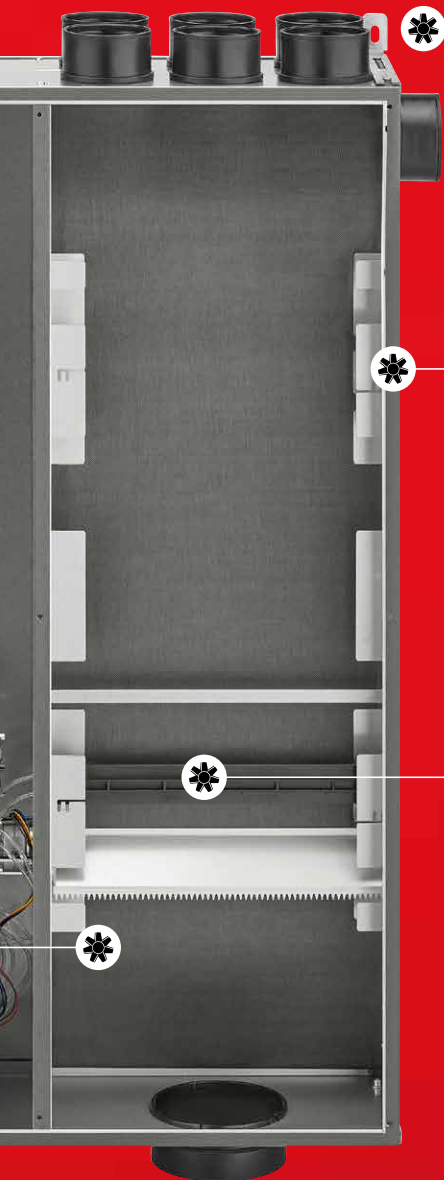

Quick installation.

One single compact box is installed rather than numerous individual components. With its integrated mounting bracket, it is also fixed into place in no time.

Maintenance-free.

Expendable and wear parts have been completely avoided in the design of the KWL® MultiZoneBox. However, the integrated inspection opening makes it easy to make sure that “all is well” if desired.

Unique.

The revolutionary technology safely ensures the predefined volume flow – independently, continuously and with the highest precision.

Ingenious tools for commissioning and operation.



Commissioning and control of complete ventilation system.

Software that leaves nothing to be desired.

The commissioning of the MultiZoneBox is convenient and fast thanks to the intuitive PC software:

- Start software > Enter air volumes > Done!
Complex and time-consuming pressure difference measurement is eliminated.
- Individual fine-tuning: Various additional configuration options are available where required.
- Once set, the defined parameters can be saved on the PC and transferred to other boxes.

Smart thing: The box in the network.

All boxes can be combined in one network* and centrally managed. It could not be any more convenient!

- The MultiZoneBox software enables the central commissioning of all boxes in the network. Optionally on-site or via the internet.
- The ultimate solution: **The highly efficient fan-optimiser.** With this technology, the performance of the central ventilation unit is permanently coordinated with the changing conditions at each MultiZoneBox. Precisely the required air volume is supplied - individually for each moment. This reduces the energy consumption without any comfort restrictions.

*using central controller KWL-ZR, Accessories.



Operation of a single KWL® MultiZoneBox

Sensor-supported operation

Extremely convenient “hands-off” operation: once set, operation is always perfect.

- Sensors for demand-controlled ventilation.
- Intelligent solution for user-independent operation.
- Available as an air humidity sensor or as a combi sensor with additional VOC detection.
- Automatic and continuous assurance of the necessary air volumes.
- For direct installation in the MultiZoneBox.

Control element TOUCH

High-quality control element with touchscreen also enables the creation of an individual weekly programme.

- Design control panel with real glass surface.
- Intuitive operation via 3.9" touchscreen (multi-language).
- Individual, manual operation: Choice of four ventilation stages and additional interval ventilation stage with freely definable air volumes.
- Automatic operation: The MultiZoneBox adjusts the air volume to the demand (using sensor, optional).
- Displays all important parameters, such as e.g. the current ventilation stage and temperature.
- Creation of an individual weekly programme.

Control element ECO

A solution that is just as economical as functional for manual or automatic operation.

- Functional and discreet LED control panel in the compact switch dimensions (80 x 80 mm).
- Individual, manual operation: Choice of four ventilation stages with freely definable air volumes.
- Automatic operation: The MultiZoneBox adjusts the air volume to the demand (using sensor, optional).
- Full power in no time at all: Activation of intensive ventilation quickly ensures the best air quality (party ventilation).

The KWL[®] MultiZoneBox range.

■ MultiZoneBox Right 90 degrees

KWL-MZB 6+1-75/125 R90

Ref no. 4050

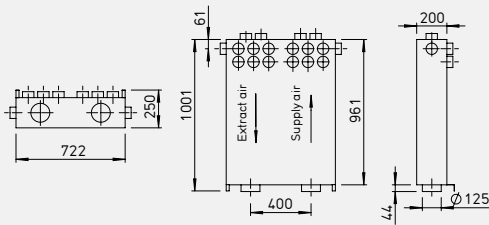

Compact unit for the connection of supply and extract air DN 125 and 2 sets of 7 single nozzles DN 75 with the supply air on the right side.

■ MultiZoneBox Left 90 degrees

KWL-MZB 6+1-75/125 L90

Ref no. 4051

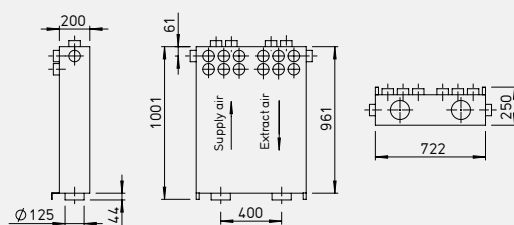

Compact unit for the connection of supply and extract air DN 125 and 2 sets of 7 single nozzles DN 75 with the supply air on the left side.

■ MultiZoneBox Straight-through 75

KWL-MZB 6+1-75/125*

Ref no. 4052

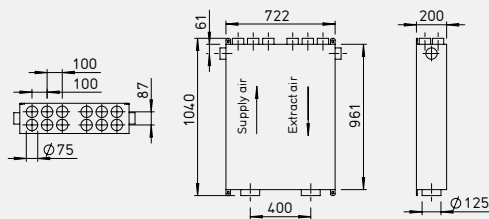

Compact unit for the connection of supply and extract air DN 125 and 2 sets of 7 single nozzles DN 75.

■ MultiZoneBox Straight-through 125

KWL-MZB 125/125*

Ref no. 4053

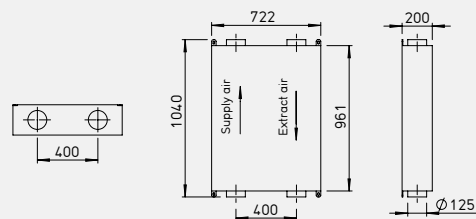

Box with one connection for both supply and extract air on each side DN 125.

■ **Control element ECO**

KWL-MZB-BE Ref no. 4213



Manual 4 stage operation or auto-
matic mode. For flush-mounting.
– Dim. (WxHxD) 80 x 80 x 10 mm
– 4-stage with LED, flush-mount. version

■ **Control element Touch**

KWL-MZB-BET Ref no. 4214



Glass touch display for controlling and
configuring the boxes.
– Dim. (WxHxD) 110 x 93 x 19 mm
– 3.9 inch display, including temperature
sensor, flush-mounted version

■ **Central controller**

KWL-MZB-ZR Ref no. 4215



Central control, configuration and
management of all connected boxes.
– Networking of up to 256 boxes
– Fan-optimiser function

■ **Connection plate**

KWL-MZB-AP Ref no. 4217



For installation in concrete ceilings.
– Dim. (WxHxD) 776 x 50 x 255 mm
– 2x 6 single nozzles DN75
– for direct connection of box to the
ducting system in the ceiling

■ **Duct support set**

KWL-MZB-RH7 Ref no. 4236



Duct support sets for bilateral connection
of FlexPipe^{® plus}.
– Set consists of 2 connection plates
per 7 holders

■ **Duct support set**

MZB-RH13 Ref no. 4249



Duct support sets for one-sided
connection of FlexPipe^{® plus}.
– consisting of 1 connection plate with
13 holders

■ **Connection set**

KWL-MZB-VSAP Ref no. 4219

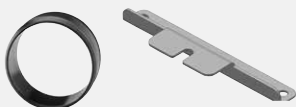

For ceiling installation with connection
plate. Set with 12 single nozzles and
mounting bracket.
– including 12 single nozzles for
connection plate

■ **Combi sensor**

KWL-MZB-VOC-F Ref no. 4216



Combi sensor (air humidity and VOC)
for installation in the MZB.
– VOC-humidity sensor
– Installation in MultiZoneBox

■ **Humidity sensor**

KWL-MZB-F Ref no. 4250

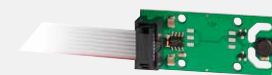

Combi sensor (air humidity and VOC)
for installation in the MZB.
– VOC-humidity sensor
– Installation in MultiZoneBox

■ **Plastic fittings DN75**

KWL-MZB KSS Ref no. 4253



Set consisting of 2 pcs, for optio-
nal, side-connection of a ventilation duct
DN75 to KWL-MZB 125/125
(Ref no.: 4053), included in scope of deli-
very for boxes 4050, 4051, 4052!

■ **Technical data**

Area of application	40 - 220 m ² /h
Voltage/frequency	1 - 230 V / 50 Hz
Max. power consumption	6 Watt
Protection class	IP 40
Weight	25 kg

All details for the individual types:
www.HeliosSelect.de



Helios Ventilatoren GmbH + Co KG · Lupfenstraße 8 · 78056 Villingen-Schwenningen · Germany
Phone + 49 (0) 77 20 / 606 - 0 · Fax + 49 (0) 77 20 / 606 - 257 · export@heliosventilatoren.de · www.heliosventilatoren.de

KWL® is a registered trademark of Helios Ventilatoren GmbH + Co KG. Copyright ©: Helios Ventilatoren GmbH + Co KG, 78056 VS-Schwenningen, Germany. Certified according to ISO 9001/2015.
Subject to technical modifications. Illustrations and information are non-binding. Document no. 28 816.844/02.18